



MATAR 5

LED-1L88-1L89EMP700PB09/PC76 C 4K##

WWW.OSMONT.CZ

MATAR 5

Product code: MAT60533

Type: LED-1L88-1L89EMP700PB09/PC76 C 4K##

Short description of the luminaire: Black color | surface-mounted LED light | ON/OFF | multipower function | polycarbonate shade



Technical

Types of luminaires	Classic on/off
Mounting type	surface mounted
Base material	aluminium
Shade material	opal polycarbonate
Base color	black Ral9005
Shade color	white
Holding the shade	spring
Mounting location	ceiling/wall
Width	900 mm
Length	92 mm
Height	56 mm
mounting holes (diameter)	2xØ5mm
Installation wire (diameter)	2xØ16mm
Energy Class	D
Impact strength	IK10
Operating temperature	from -20°C to +30°C

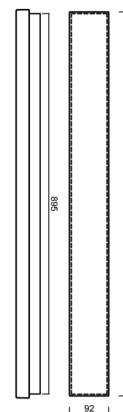

Electric

Power consumption	26 W
Ingress Protection	IP44
Socket	LED modul
terminal block	snap terminal block
Automatic circuit breaker type B10A	37 pcs
Automatic circuit breaker type B16A	59 pcs
Automatic circuit breaker type C10A	37 pcs
Automatic circuit breaker type C16A	59 pcs

Luminous

Lum. flux of luminaire	2830 lm
Lum. flux of light source	4360 lm
Luminaire efficacy	108 lm/W
Temperature	4000 K
Rated life time LED L80/B10	100000 hours
CRI	Ra80
MacAdam	3
Blue light hazard	Risk group 0

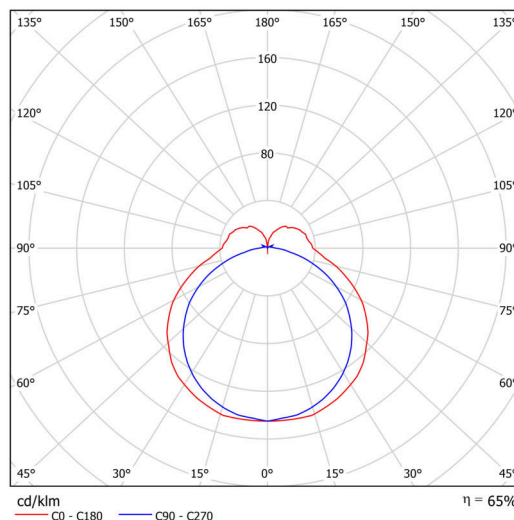

Eulum data for calculation programs are available at www.osmont.cz.

TECHNICAL SHEET



Multipower

Possibility of output adjustment by the user (DIP switch on the current source).

I [mA]	700	600	500	400	
[%]	100	86	71	57	

Logistic

EAN	8591728088507
Number of cartons	1 pcs
Package 1 width	0.94 m
Package 1 length	0.12 m
Package 1 height	0.08 m
Warranty*	60 months

*The warranty for the batteries is valid for 12 months from the date of purchase.

Installation dimensions:

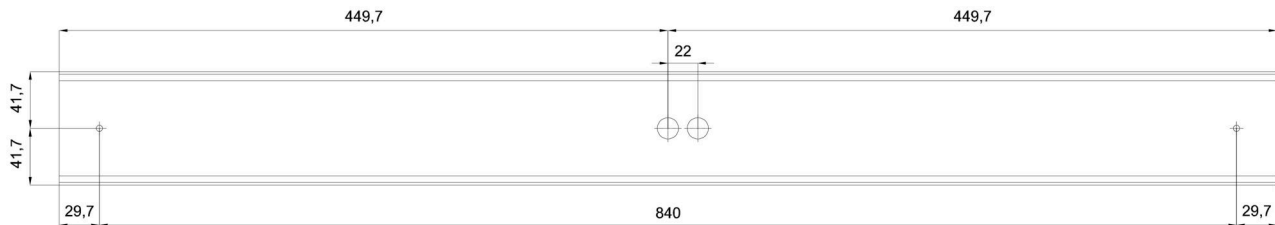

Additional assortment:

Base for surface mounting

Product code	Name	Color	Description	Picture	Drawing
33526	držák pro povrchovou montáž MATAR 4,5,6 (80x40x40,tl .1,Fe) nikl	white Ra19003			

Lampshade

Product code	Name	Color	Description	Picture	Drawing
20617	PC76	white		