



## MATAR 3

---

LED-2L79E500PA12/PC73 C 4K##

[WWW.OSMONT.CZ](http://WWW.OSMONT.CZ)

# MATAR 3

Product code: MAT60506

Type: LED-2L79E500PA12/PC73 C 4K##

Short description of the luminaire: Black color | surface-mounted LED light | ON/OFF | polycarbonate shade

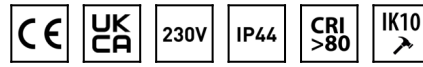

## Technical

Types of luminaires	Classic on/off
Mounting type	surface mounted
Base material	aluminium
Shade material	opal polycarbonate
Base color	black Ral9005
Shade color	white
Holding the shade	spring
Mounting location	ceiling/wall
Width	1200 mm
Length	60 mm
Height	46 mm
mounting holes (diameter)	2xØ5mm
Installation wire (diameter)	2xØ16mm
Energy Class	D
Impact strength	IK10
Operating temperature	from -20°C to +30°C

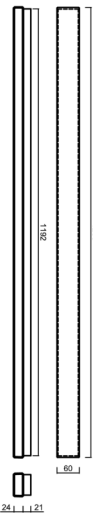

## Electric

Power consumption	18 W
Ingress Protection	IP44
Socket	LED modul
terminal block	snap terminal block
Automatic circuit breaker type B10A	37 pcs
Automatic circuit breaker type B16A	59 pcs
Automatic circuit breaker type C10A	37 pcs
Automatic circuit breaker type C16A	59 pcs

## Luminous

Lum. flux of luminaire	2280 lm
Lum. flux of light source	3210 lm
Luminaire efficacy	126 lm/W
Temperature	4000 K
Rated life time LED L80/B10	100000 hours
CRI	Ra80
MacAdam	3
Blue light hazard	Risk group 0

Eulum data for calculation programs are available at [www.osmont.cz](http://www.osmont.cz).

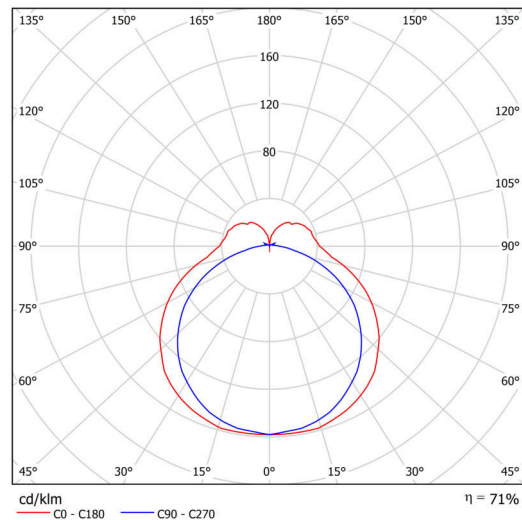

# TECHNICAL SHEET



## Logistic

EAN	8591728088231
Weight NTTO	1.3 Kg
Weight BTTO	1.46 Kg
Warranty*	60 months

*\*The warranty for the batteries is valid for 12 months from the date of purchase.*

## Installation dimensions:

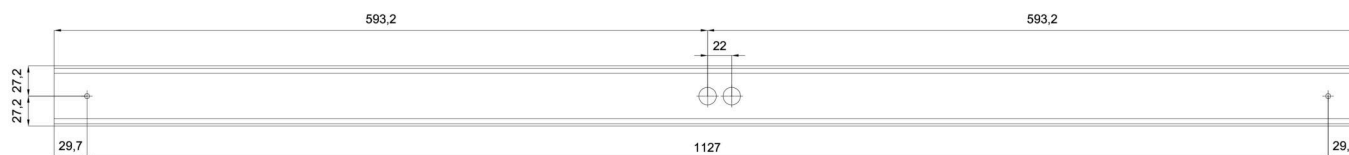

## Additional assortment:

## Lampshade

Product code	Name	Color	Description	Picture	Drawing
20615	PC73	white		