



## KRUGER 1 FOP

LED-1L14E700KN63/FOP1C HF CORR 3K#

[WWW.OSMONT.CZ](http://WWW.OSMONT.CZ)

# KRUGER 1 FOP

Product code: KRU60047

Type: LED-1L14E700KN63/FOP1C HF CORR 3K#

Short description of the luminaire: White color | surface-mounted LED light | CORRIDOR function (HF+DALI) | opal prismatic shade | decorative collar

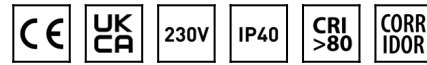

## Technical

|                              |  |
|------------------------------|--|
| Types of luminaires          | Corridor                                       |
| Mounting type                | surface mounted                                |
| Base material                | steel  |
| Shade material               | Plastic opal prismatic (FOP) with metal collar |
| Base color                   | black Ral9005                                  |
| Shade color                  | white - black                                  |
| Holding the shade            | folding system                                 |
| Mounting location            | ceiling/wall                                   |
| Width                        | 300 mm   |
| Length                       | 300 mm   |
| Height                       | 80 mm  |
| Diameter                     | ø 300 mm                                       |
| mounting holes (diameter)    | 3xø5mm   |
| Installation wire (diameter) | 2xø16mm  |
| Energy Class                 | D  |
| Operating temperature        | from -20°C to +30°C                            |

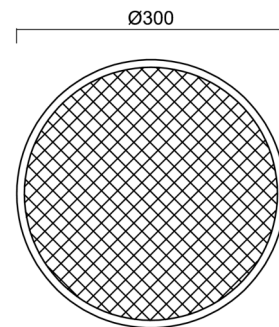

## Electric

|                                     |                     |
|-------------------------------------|---------------------|
| Power consumption                   | 18 W                |
| Ingress Protection                  | IP40                |
| Socket                              | LED modul           |
| Sensor                              | HF                  |
| terminal block                      | snap terminal block |
| Automatic circuit breaker type B10A | 21 pcs              |
| Automatic circuit breaker type B16A | 35 pcs              |
| Automatic circuit breaker type C10A | 35 pcs              |
| Automatic circuit breaker type C16A | 58 pcs              |

## Luminous

|                             |              |
|-----------------------------|--------------|
| Lum. flux of luminaire      | 1450 lm      |
| Lum. flux of light source   | 2690 lm      |
| Luminaire efficacy          | 80 lm/W      |
| Temperature                 | 3000 K       |
| Rated life time LED L80/B10 | 100000 hours |
| CRI                         | Ra80         |
| MacAdam                     | 3            |
| Blue light hazard           | Risk group 0 |

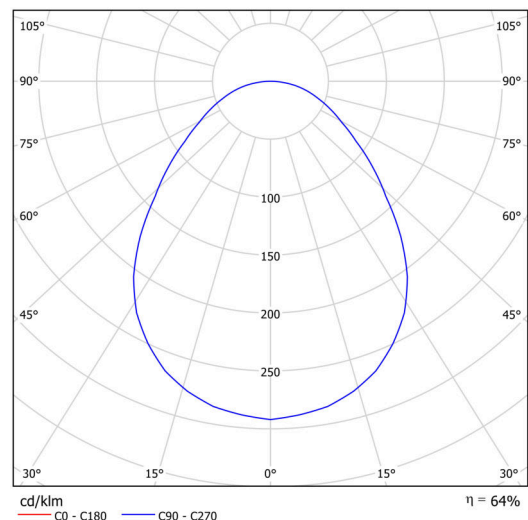

Eulum data for calculation programs are available at [www.osmont.cz](http://www.osmont.cz).

Logistic

|             |               |
|-------------|---------------|
| EAN         | 8591728081164 |
| Weight NTT0 | 1.6 Kg        |
| Weight BTTO | 1.9 Kg        |
| Warranty*   | 60 months     |

\*The warranty for the batteries is valid for 12 months from the date of purchase.

Installation dimensions:

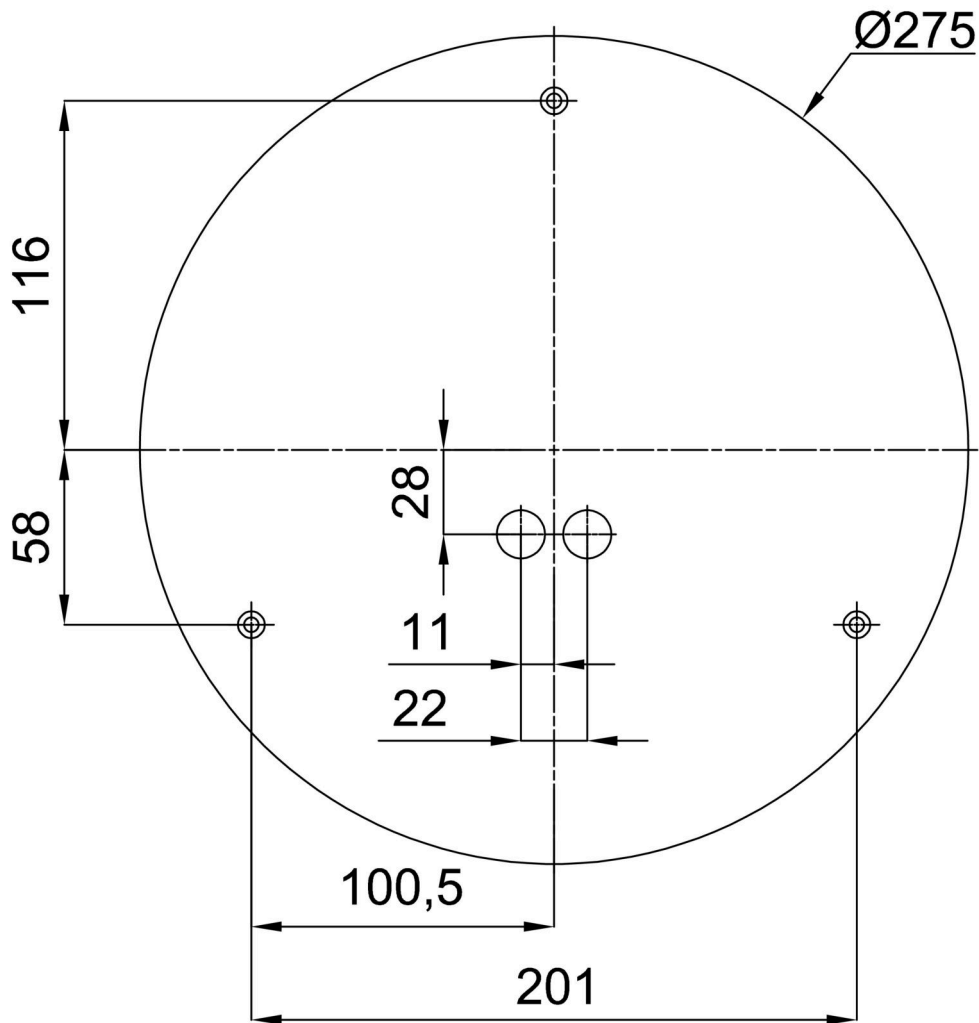

Additional assortment:

Base for surface mounting

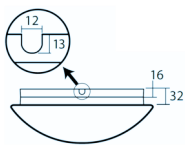
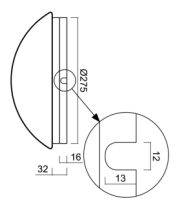
| Product code | Name      | Color            | Description | Picture  | Drawing   |
|--------------|-----------|------------------|-------------|--|---|
| 33501        | KN6,K6/BP | white<br>Ra19003 |             |  |  |

Lampshade

| Product code | Name  | Color            | Description | Picture  | Drawing |
|--------------|-------|------------------|-------------|--|---------|
| 20635        | FOP1C | white -<br>black |             |  |         |