



## LINA 7

---

LED-1L16EMP700K88/139 NK3HST 3K#

[WWW.OSMONT.CZ](http://WWW.OSMONT.CZ)

# LINA 7

Product code: LIN67476

Type: LED-1L16EMP700K88/139 NK3HST 3K#

Short description of the luminaire: White colour | ceiling or wall LED light with emergency backup combined ( with Self-test) | TRIPLEX OPAL hand blown glass shade|

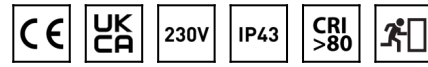

## Technical

Types of luminaires	Emergency combined
Mounting type	surface mounted
Base material	steel
Shade material	three-layer glass TRIPLEX OPAL
Base color	white Ral9003
Shade color	white
Holding the shade	folding system
Mounting location	ceiling/wall
Width	440 mm
Length	440 mm
Height	125 mm
mounting holes (diameter)	4xØ5mm
Cable entrance	2xØ16mm
Energy Class	D
Impact strength	IK01
Operating temperature	from 0°C to +30°C

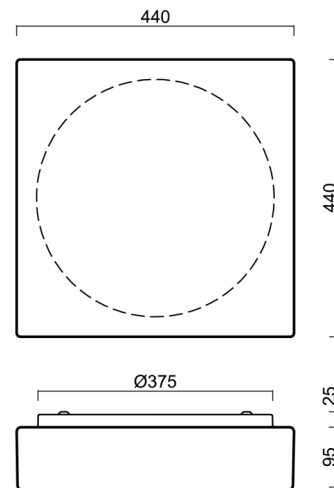

## Electric

Power consumption	34 W
Ingress Protection	IP43
Socket	LED modul
Battery type	LiFePO4
Emergency time	3 hours
SELFTEST	yes
terminal block	snap terminal block

## Luminous

Lum. flux of luminaire	3640 lm
Lum. flux of light source	5050 lm
Lum. flux of light source in emergency mode	200 lm
Temperature	3000 K
Rated life time LED L80/B10	100000 hours
CRI	Ra80
MacAdam	3
Blue light hazard	Risk group 0

Eulum data for calculation programs are available at [www.osmont.cz](http://www.osmont.cz).

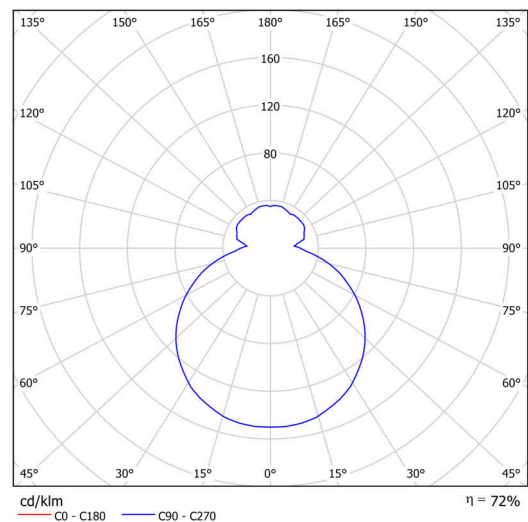

Logistic

EAN	8591728158774
Weight NTTO	6.8 Kg
Weight BTTO	7.3 Kg
Number of cartons	1 pcs
Package volume	0.026 m <sup>3</sup>
Package 1 width	0.455 m
Package 1 length	0.455 m
Package 1 height	0.125 m
Warranty*	60 months

\*The warranty for the batteries is valid for 12 months from the date of purchase.

Installation dimensions:

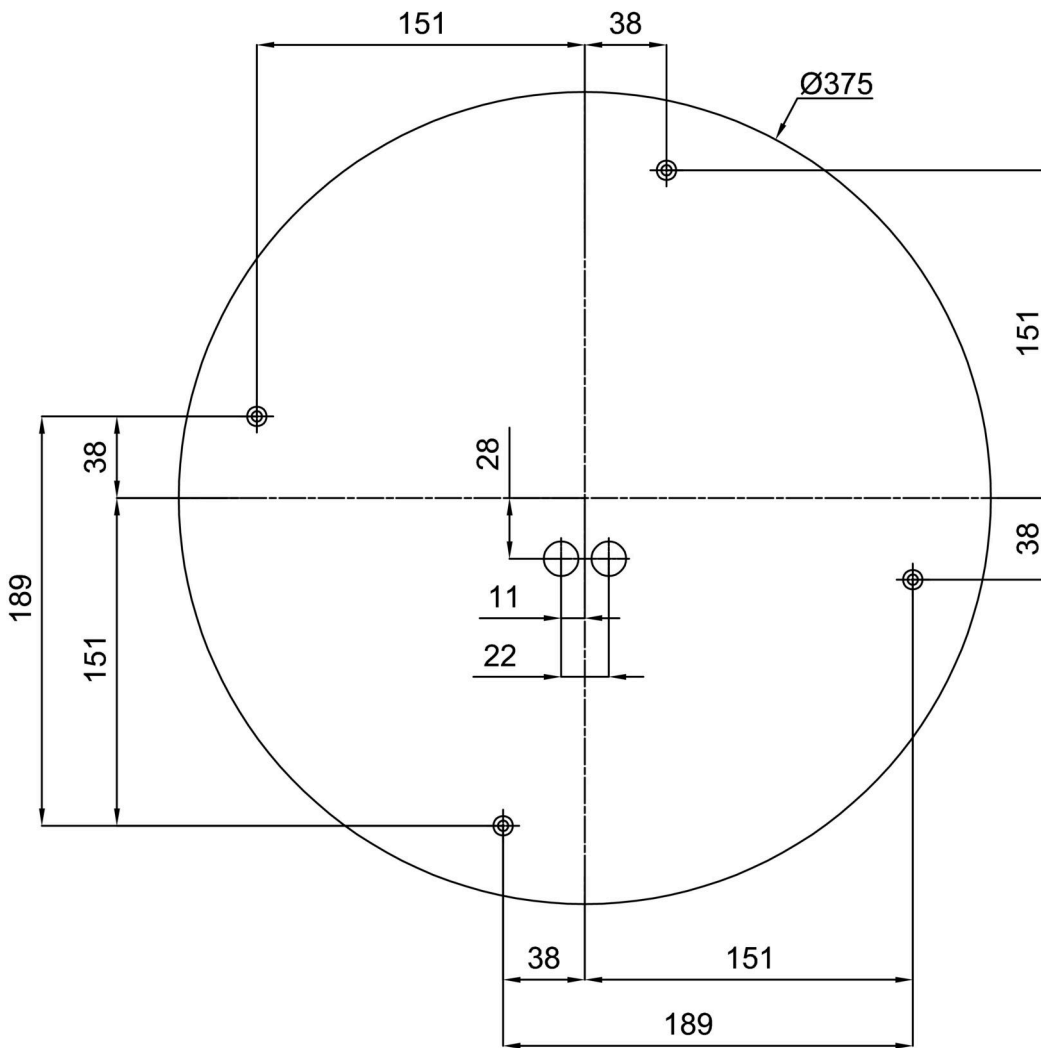

Additional assortment:

Base for surface mounting

Product code	Name	Color	Description	Picture	Drawing
33502	KN8,K8/BP	white Ra19003	příslušenství		

Lampshade

Product code	Name	Color	Description	Picture	Drawing
20071	139	white	příslušenství	